

Syringe Driver - Plunger

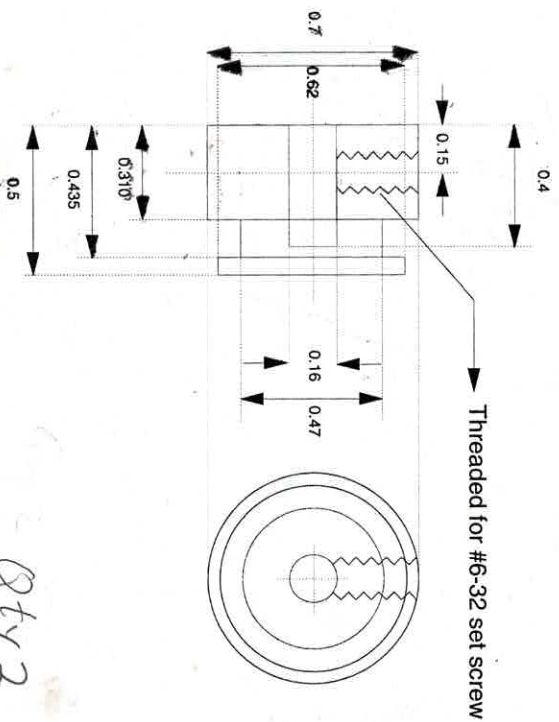

Material : **Stainless Steel**

Threaded Rod

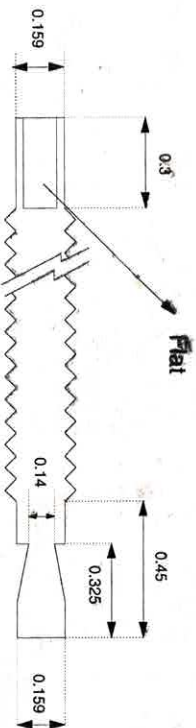

Material : ~~Aluminum (anodized)~~ **S.S.**

~~Suri, 43562~~

All dimensions in inches

1254

Syringe Driver - Slider

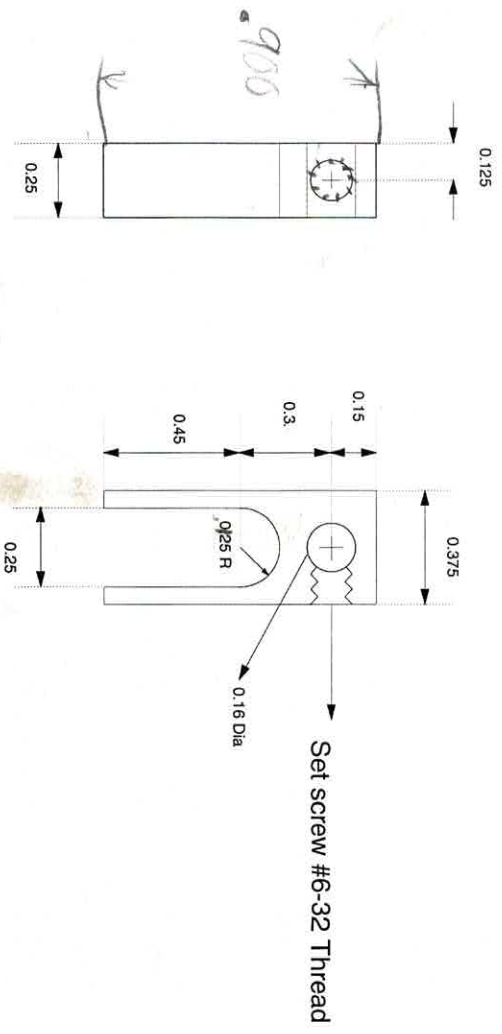

Syringe Driver - Syringe holder

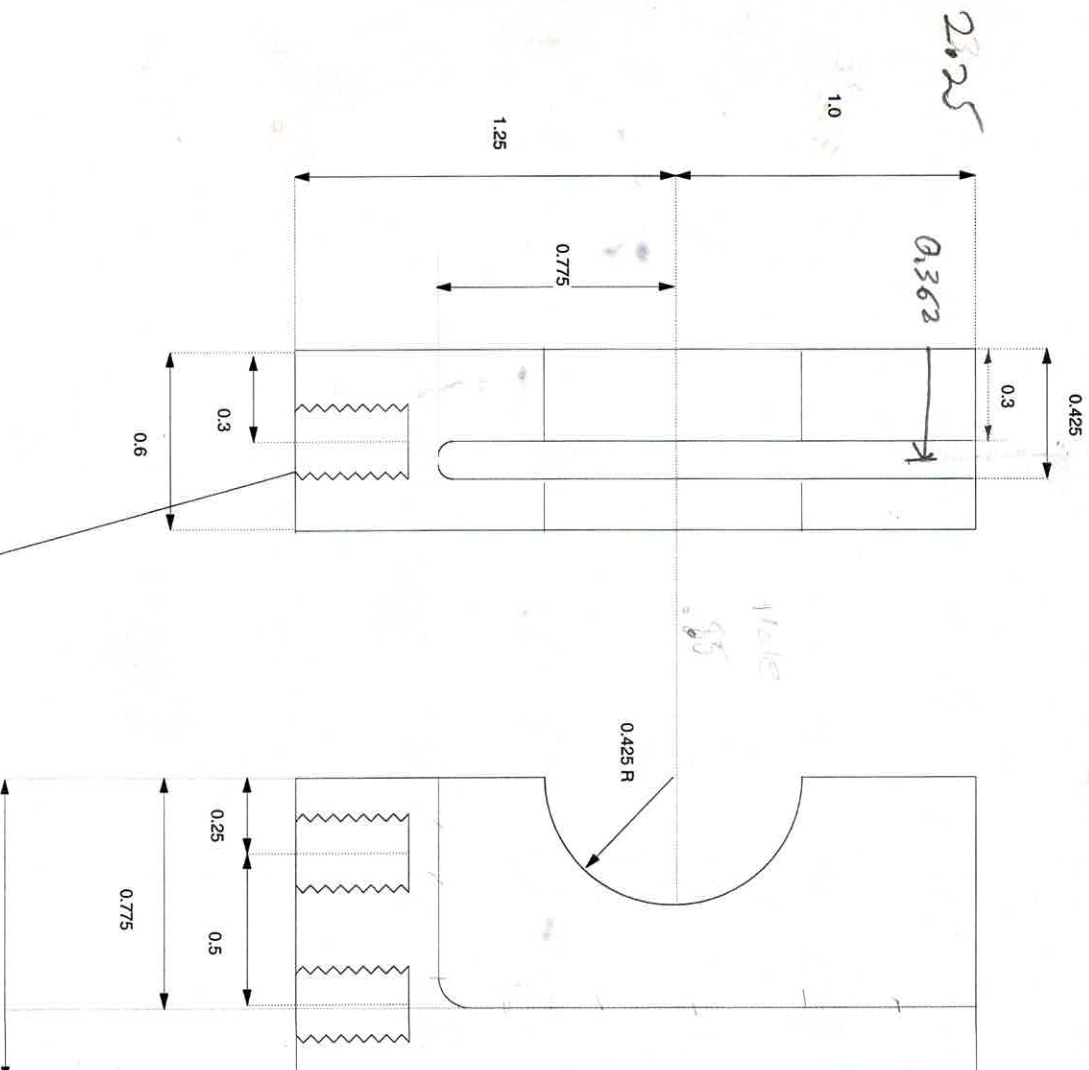

Tapped for 1/4 - 20 (0.375 deep) X2

Material : Aluminium (anodized)

Qty : 2

Suri, 43562 (Physics)

All dimensions in inches

1254

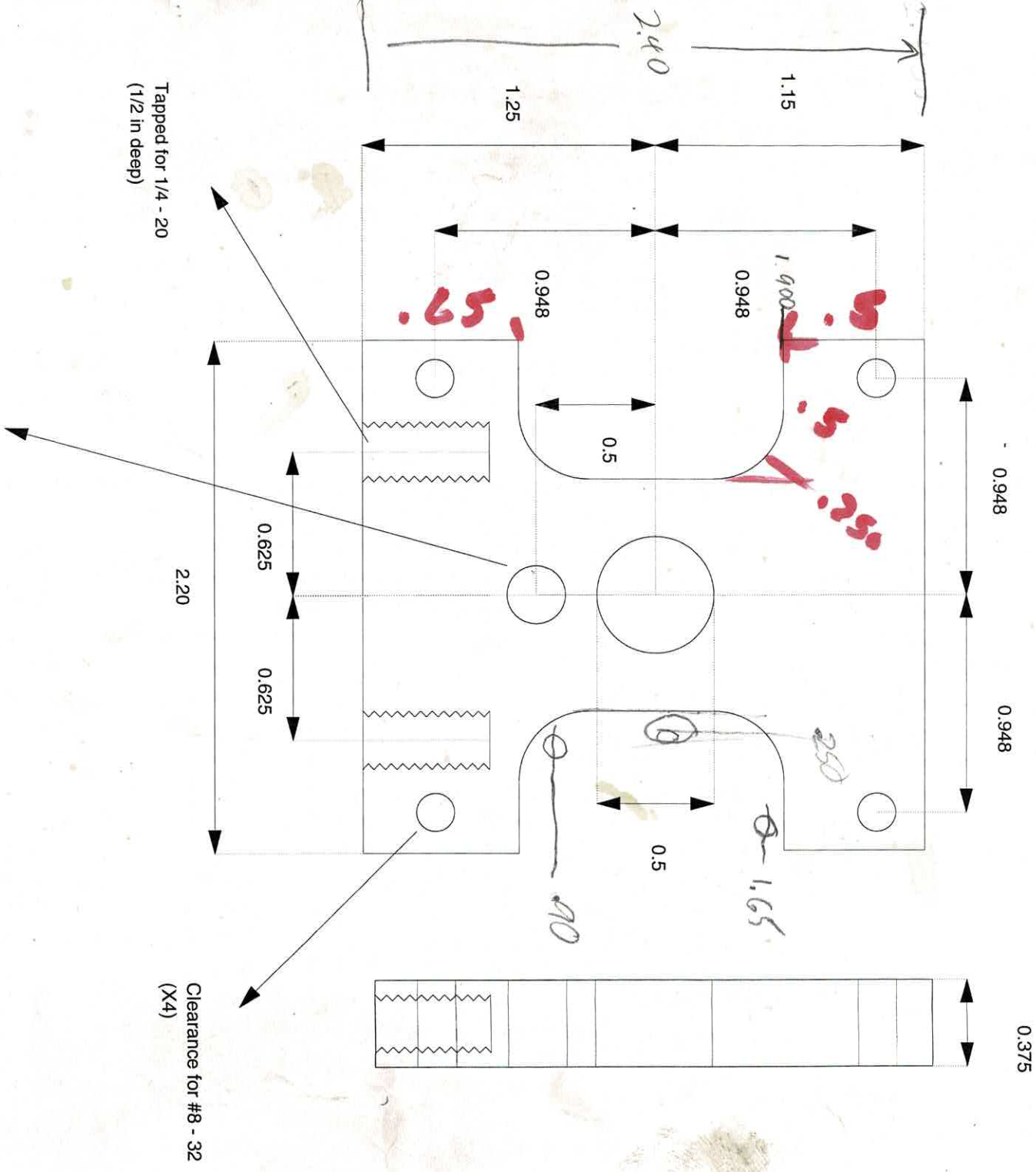

Syringe Driver - Motor mounting plate

Material : Aluminium (anodized)

Qty : 2

Suri, 43562

All dimensions in inches

Syringe Driver - Base plate

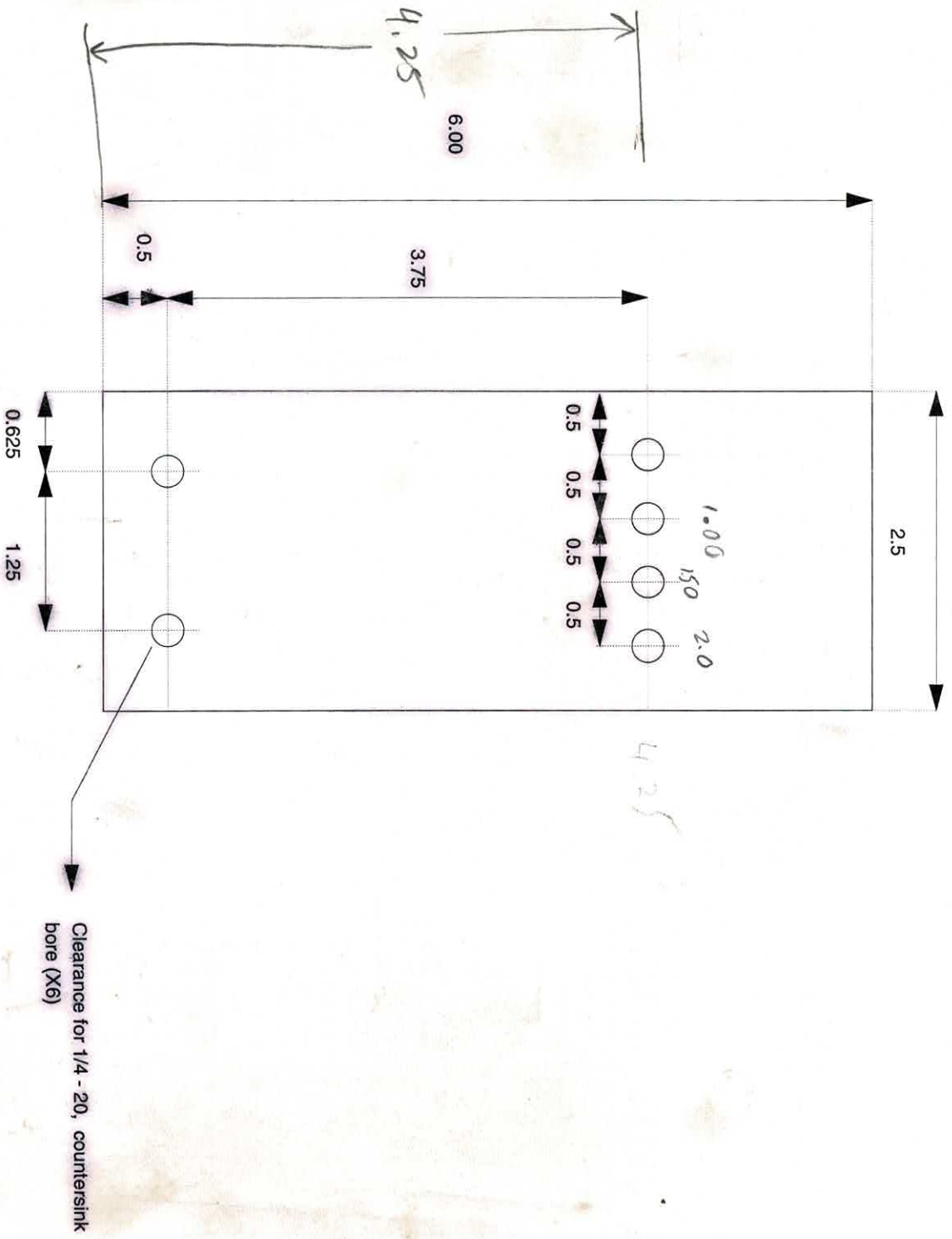

Material : Aluminium (anodized)
Qty : 1

Suri, 43562

All dimensions in inches

1254